

ZSHP



ZSHPSC

ADJUSTING INSTRUCTIONS

Before fitting it is advised to decrease the torque (see Fig 2).

To increase Torque (Fig 1)

- Close door
- Engage 5/32" hex wrench
- Rotate clockwise to increase torque
- Do not exceed 6 ratchet "clicks"

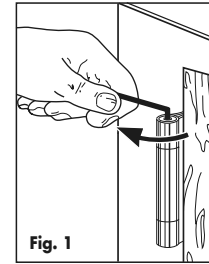

Fig. 1

To Decrease Torque (Fig 2)

- Close door
- Engage 5/32" hex wrench
- Firmly depress wrench to disengage ratchet mechanism
- Let wrench rotate counte-clockwise to new setting
- Allow wrench to rise

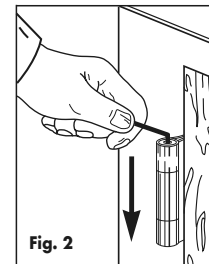

Fig. 2

Install Locking Safety Screw (Fig 3)

- Install 6-32 5/8" recessed head machine screw packed with hinge.



Fig. 3

SPECIFICATION

- Dimensions : 3.5" x 3.5" x 2.5mm
- 2 sprung + 1 unsprung hinge

SUITABILITY



TECHNICAL

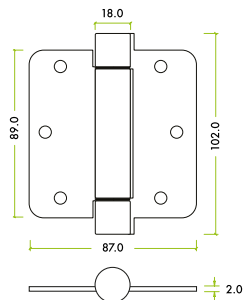

CODE	DESCRIPTION	FINISH
ZSHPCP	Spring hinge plus slave pack	Polished Chrome
ZSHPSC	Spring hinge plus slave pack	Satin Chrome

ZOO

ARCHITECTURAL HARDWARE

For more information please contact us today:

ERA Home Security T/A Zoo Hardware,
Unit B, Dukes Drive, Kingmoor Park North,
Carlisle, Cumbria CA6 4SH

Call: 01228 672900

Fax: 01228 672928

Email: sales@zoo-hardware.co.uk

Web: www.zoohardware.co.uk



FM 668401

EMS 668402